

Navigation Switches Series SF25WA



PAT. M467996
PAT. ZL201320515373.3

Feature

- Panel cutting Ø25mm
- IP67
- 5 Key Navigation Switches
- LED Illuminated
- SUS 316 stainless steel housing
- Custom Laser etch

General Specifications

Switch Circuit :SP5T (5-key Common bus)
Switch contact Rating :50mA @ 12V DC max
LED Rating :Limited forward current(IF) at 20mA max.
Contact Resistance :1 Ohm Max.(initial)
Insulation Resistance :100M Ohm Min.
Operating Force :400gf±100gf
Total Travel :1.0mm±0.3mm
Mechanical Life :100,000 cycles Min.
Operating Temperature :-10 °C ~ +60 °C

Materials

Housing :SUS 316
Cap :Silicone
Tactile Switches :LCP,SUS silver plating, Cyanide silver plating
PCB :FR4
FFC :PET
Washer :NBR
Nuts :Polyamide (PA)

Contact Configuration & Panel cutting

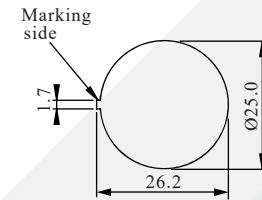
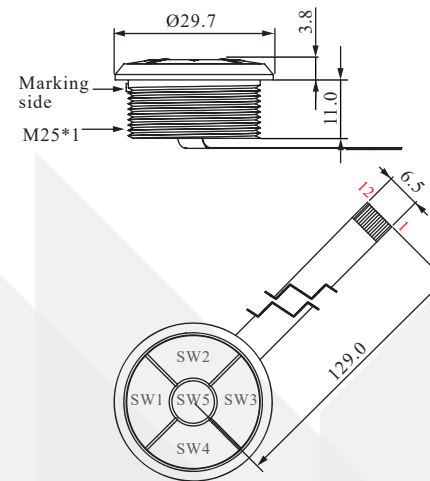

Panel cutting
Panel thickness :
1.5~4mm

Contact Configuration

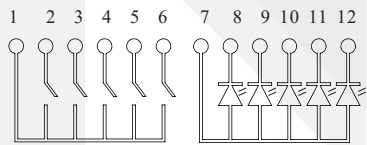

Recommend add resistor to limited each LED forward current at 20mA

Pin	Function	Pin	Function
1	SW COM.	7	LED (+)
2	SW 1 N.O.	8	SW 1 LED(-)
3	SW 2 N.O.	9	SW 2 LED(-)
4	SW 3 N.O.	10	SW 3 LED(-)
5	SW 4 N.O.	11	SW 4 LED(-)
6	SW 5 N.O.	12	SW 5 LED(-)

The Connector for SF25WA module is YCN007 or similar JST 12FLZT-SM1-TF
Applicable FFC: Conductor pitch / 0.5mm
Conductor width / 0.3mm
Mating part thickness / 0.30±0.05mm

How to order



SF25WA7A52

Blue LED /
Black Housing /
Paint Black Cap



SF25WA1B42

Red LED /
Silver Housing /
Paint White Cap

- * Color is subject to actual product.
- * We provide Laser Marking service.

Option



Adapter: YPS009



How to use:
For Cable hand Soldering
or for Connector