

TACT SWITCH
T5WJ SERIES

Long Travel J SMT
 Washable Type



FEATURES

- ※5.25x5.4mm with long travel
- ※Less activation sound
- ※Clear operation feeling
- ※Sealed IP67

APPLICATION

- ※Automotive
- ※Gaming
- ※Smart metering
- ※Industrial

SPECIFICATION

Contact Rating	10uA, 1V DC min. 50mA, 16V DC max.
Contact Resistance	100mΩ max.(initial)
Insulation Resistance	100MΩ min.
Dielectric Strength	250V AC/1 minute
Operating Force	350±60gf
Operating Life	250,000 cycles min.
Operating Temp.	-40°C ~ +105°C
Storage Temp.	-40°C ~ +105°C

HOW TO ORDER

T 5 W J □ □ □ G Q R

- J Bend
- Total Height & Operating Force:
1G=3.85mm;350gf(G=Green)
2S=4.34mm;300gf(S=Salmon)
- Package:
Tape & Reel
- Halogen Free
- Plating:
G=Silver Plating
- Actuator Type:
D=Dome/Convex
F=Flat

CIRCUIT

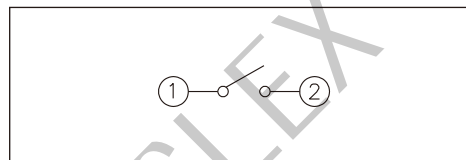

PACKAGE

<Tape & Reel>
 1900 pcs

T5WJ

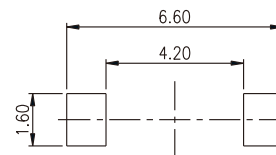
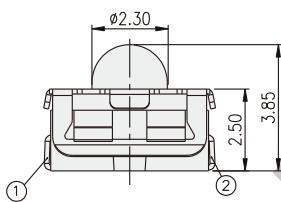
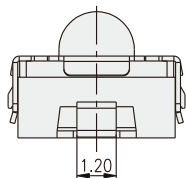
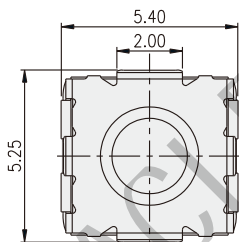

P.C.B. LAYOUT

TACT SWITCH