



SPECIFICATIONS

- RATING:** Max : 2A / 36VDC ; Min : 0.5A / 12VDC.
- ELECTRICAL LIFE:** 200,000 make-and-break cycles at full load
- MECHANICAL LIFE:** 1,000,000 cycles
- INSULATION RESISTANCE:** 1,000 MΩ min. at 500VDC
- DIELECTRIC STRENGTH:** 2,000V RMS @ sea level (initial value)
- CONTACT RESISTANCE:** 50 mΩ max.
- OPERATION TEMPERATURE:** -20°C~+70°C
- TRAVEL:** About 2.0±0.20mm
- OPERATION PRESSURE:** 4.5N±1.5N
- INGRESS PROTECTION:** IP67(In house test)
- TORQUE:** 11.5 kgf · cm

MATERIALS

- BUSHING:** Aluminum alloy / Stainless Steel
- BASE:** PBT (UL 94-V0)
- ACTUATOR:** PC (Translucent UL 94-V2)
- CAP:** Aluminum alloy / Stainless Steel
- SPRING:** Steel.
- SEALING:** Silicone (Translucent).
- O-Ring:** Silicone (Translucent).
- TERMINAL:** Brass, Gold flash plated.
- CONTACT:** Silver alloy.
- HEX NUT:** Brass (Nickel plated).

HOW TO ORDER

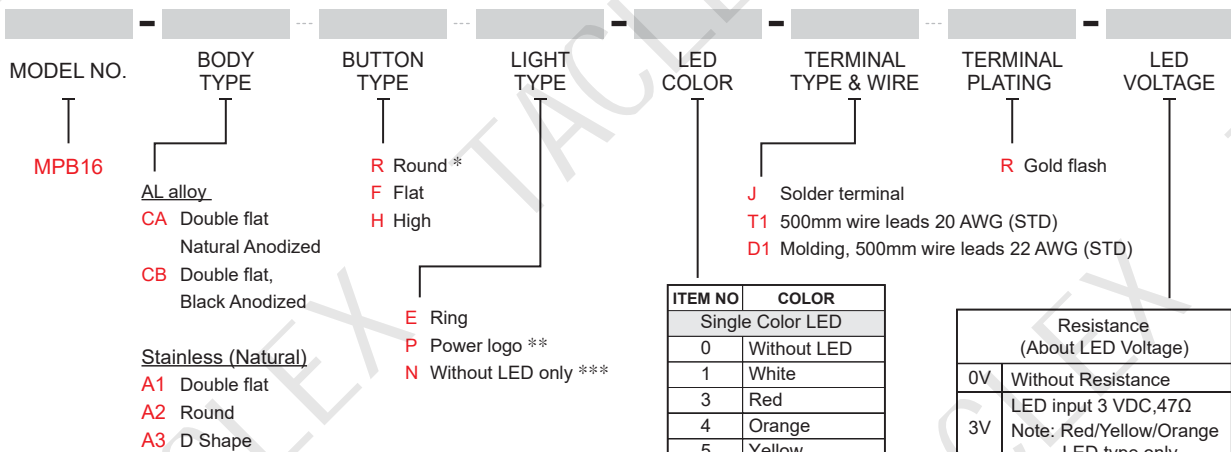

ITEM NO	COLOR
Single Color LED	
0	Without LED
1	White
3	Red
4	Orange
5	Yellow
6	Green
7	Blue
Dual Color LED	
A	Red+Green
RGB Color LED	
RGB	Red/Green/Blue

Resistance (About LED Voltage)	
0V	Without Resistance
3V	LED input 3 VDC, 47Ω Note: Red/Yellow/Orange LED type only
6V	LED input 6 VDC, 180Ω
12V	LED input 12 VDC, 470Ω
24V	LED input 24 VDC, 1000Ω

* ohms value of resistance tolerance: ±5%

* Current limiting resistor is required to limit LED forward current to 20mA.

- * For body type CA and CB only
- ** Not applicable for button type H
- *** For button type H only
- **** Except standard color, for other colors information please consult sales representative.

EXAMPLE:

MPB16-CARE-0-JR-0 (Without LED)

MPB16-CARE-□-JR-□V





▼ **CIRCUIT**

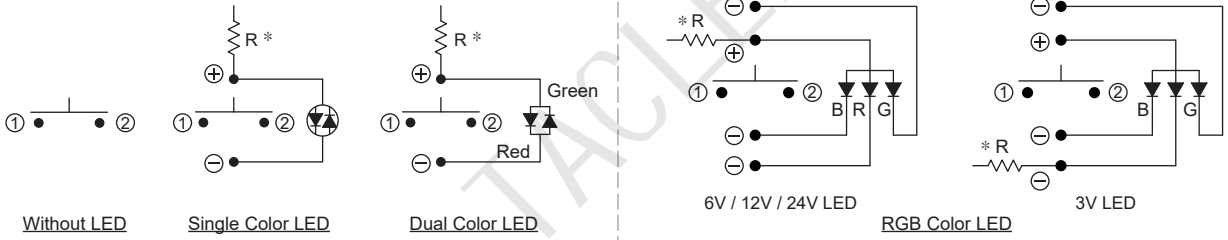

* Note: According to the input voltage adjustment resistance.

▼ **BODY OPTIONS**

CA / CB Double flat

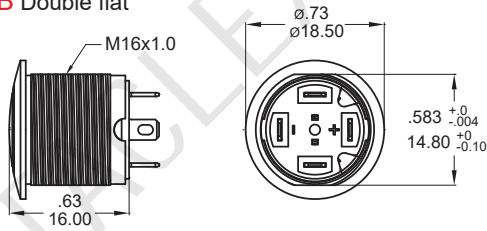

Note: Available with round button only

A1 Double flat

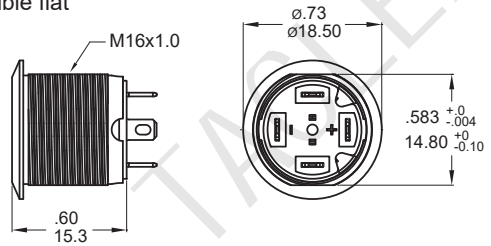

A2 Round

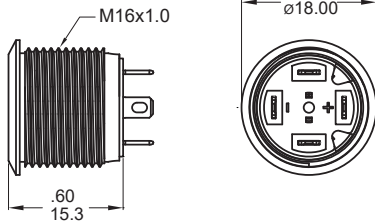

A3 D Shape

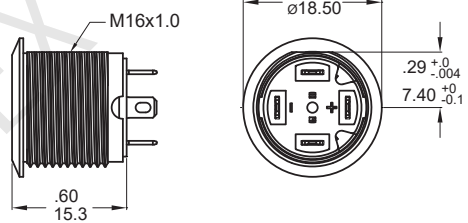

▼ **BUTTON OPTIONS**

R Round

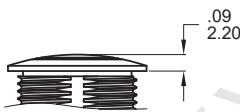

Note: Available with body type CA and CB only

H High *

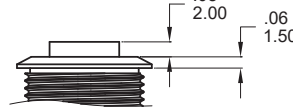

* Note: Available with body type A1~A3 only

F Flat *

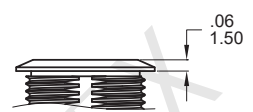

▼ **LIGHT OPTIONS**

E Ring

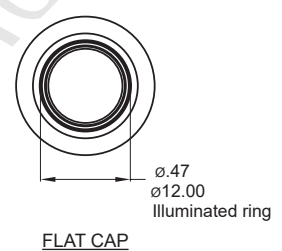
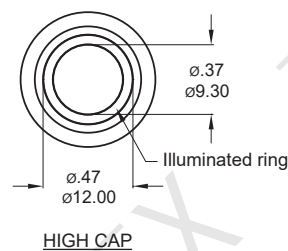
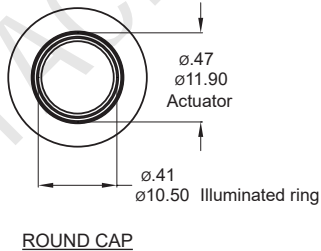

P Power logo

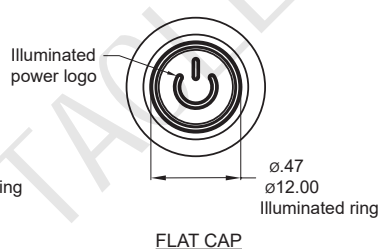
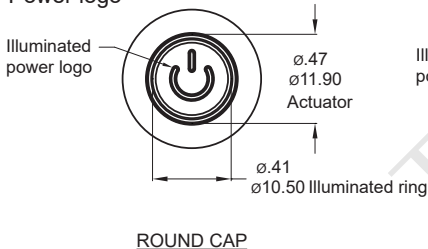

N Without LED

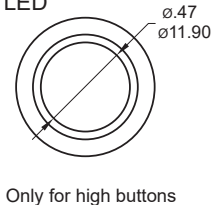



▼ PANEL MOUNTING

Panel thickness:
8.0 mm (.031inch) MAX.

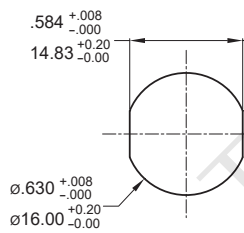

Double flat

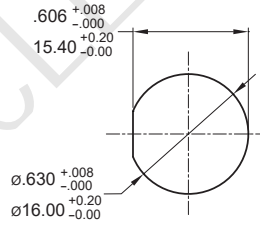

D shape

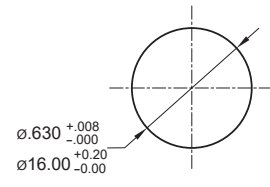

Round

▼ DIMENSION

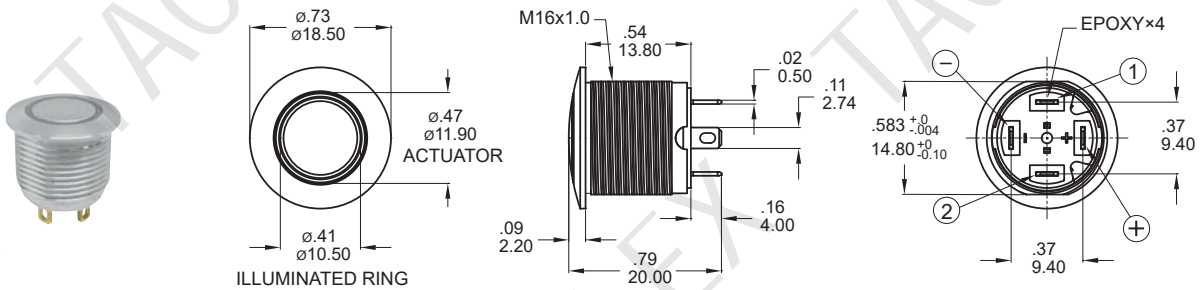

Model name. MPB16-CARE-1-JR-0V

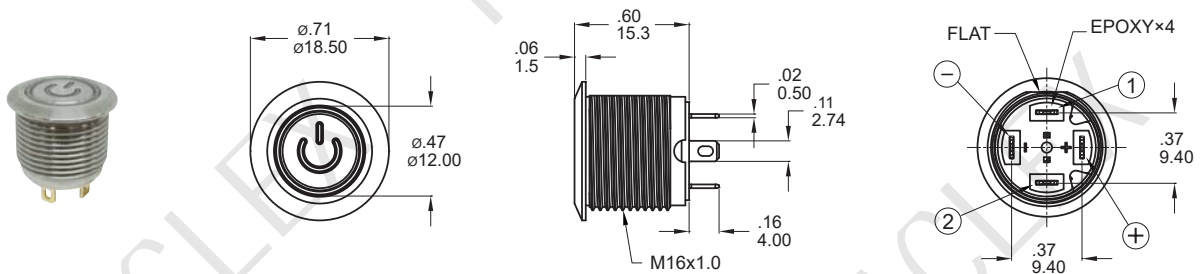

Model name. MPB16-A3FP-1-JR-0V

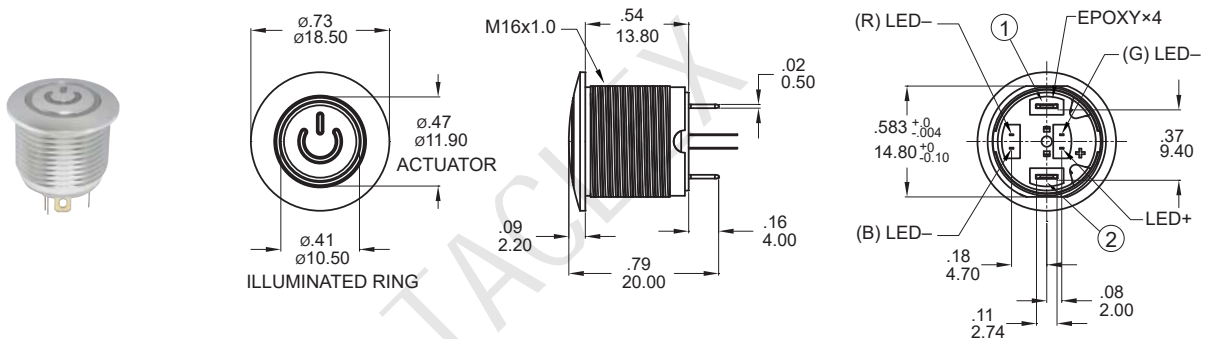

Model name. MPB16-CARP-RGB-JR-0V



▼ **WIRE OPTIONS**

* Please consult sales for additional wire options.

T1 500mm wire leads 20 AWG

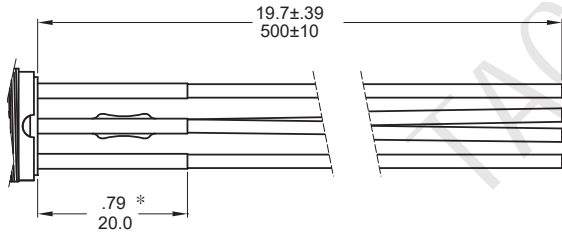

Heat shrink tube

*Note: No external resistance heat shrink sleeve .39inch(10mm).

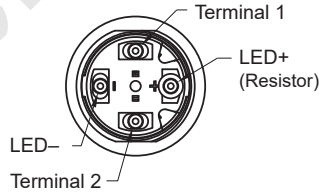

Wires:

- Black wire - Terminal
- Red wire - LED (+) Positive
- Green wire - LED (-) Negative

* No Illumination: Black Wire - Terminal

T1 500mm wire leads 20 AWG (RGB LED)

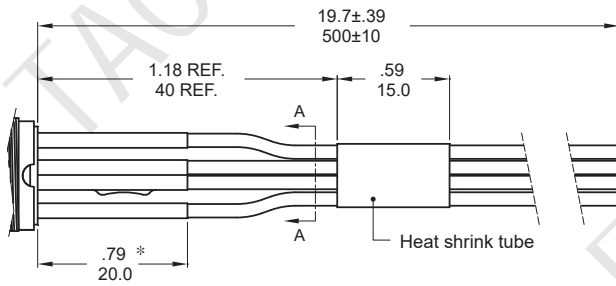

Heat shrink tube

*Note: No external resistance heat shrink sleeve .39inch(10mm).

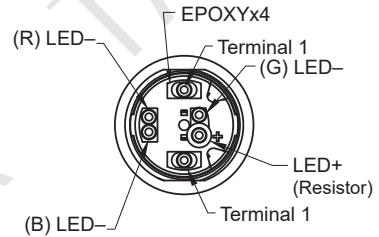

SECTION A-A

Wires:

- Black wire - Terminal
- White wire - LED (+) Positive
- Red wire - (R)LED (-) Negative
- Blue wire - (G)LED (-) Negative
- Green wire - (B)LED (-) Negative

D1 Molding, 500mm wire leads 22 AWG

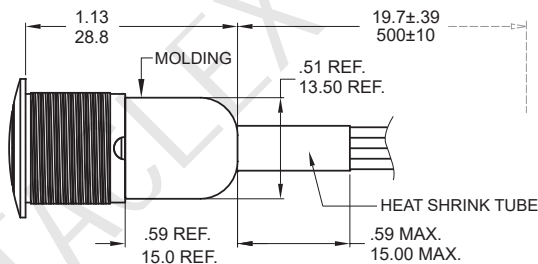

Wires:

- Black wire - Terminal
- Red wire - LED (+) Positive
- Green wire - LED (-) Negative

* No Illumination: Black Wire - Terminal

RGB LED Wires:

- Black wire - Terminal
- White wire - LED (+) Positive
- Red wire - (R)LED (-) Negative
- Blue wire - (G)LED (-) Negative
- Green wire - (B)LED (-) Negative

▼ **HARDWARE**

- * Standard hardware : 1 nut, 1 O-ring
- * For further information please consult sales representative.

O-RING (Std.)

Model name. FCP-MP602

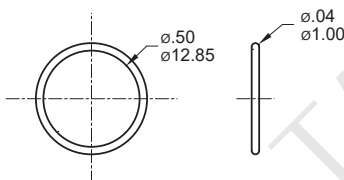

NUT (Std.)

Model name. MNU-PY01

