

TACT SWITCH  
**T5WJ** SERIES

Long Travel J SMT  
 Washable Type

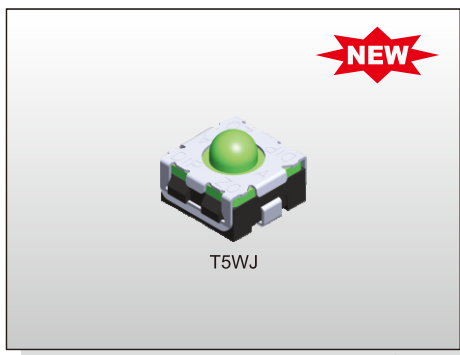

**FEATURES**

- ※5.25x5.4mm with long travel
- ※Less activation sound
- ※Clear operation feeling
- ※Sealed IP67

**APPLICATION**

- ※Automotive
- ※Gaming
- ※Smart metering
- ※Industrial

**SPECIFICATION**

Contact Rating	10uA, 1V DC min. 50mA, 16V DC max.
Contact Resistance	100mΩ max.(initial)
Insulation Resistance	100MΩ min.
Dielectric Strength	250V AC/1 minute
Operating Force	350±60gf
Operating Life	250,000 cycles min.
Operating Temp.	-40°C ~ +105°C
Storage Temp.	-40°C ~ +105°C

**HOW TO ORDER**

T 5 W J □ □ □ G Q R

- J Bend
- Total Height & Operating Force:  
1G=3.85mm;350gf(G=Green)  
2S=4.34mm;300gf(S=Salmon)
- Package:  
Tape & Reel
- Halogen Free
- Plating:  
G=Silver Plating
- Actuator Type:  
D=Dome/Convex  
F=Flat

**CIRCUIT**

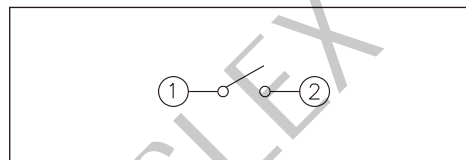

**PACKAGE**

<Tape & Reel>  
 1900 pcs

**T5WJ**

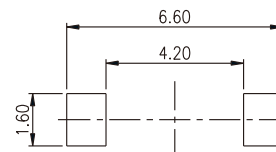
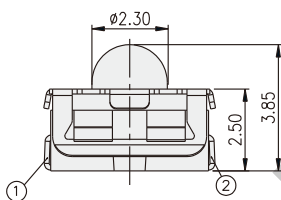
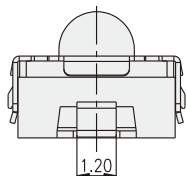
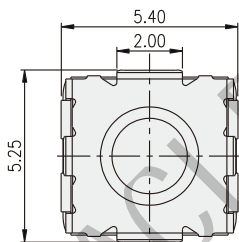

P.C.B. LAYOUT