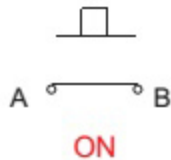
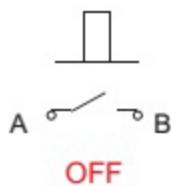
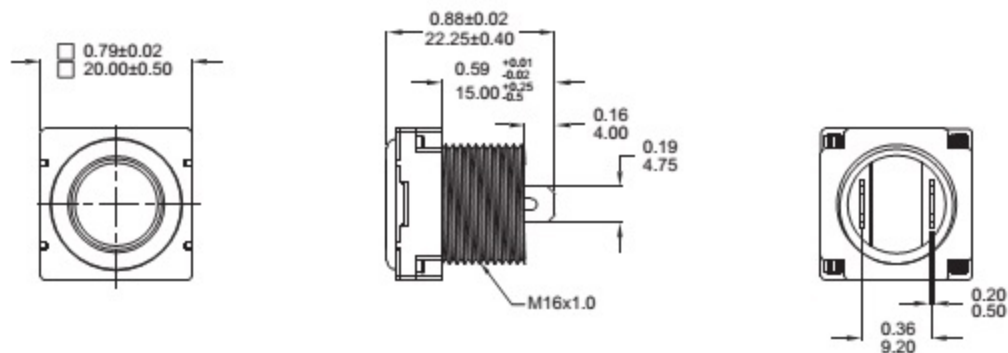
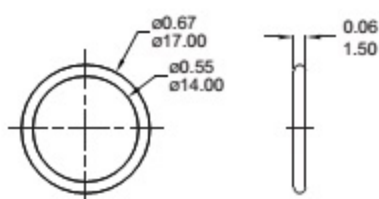
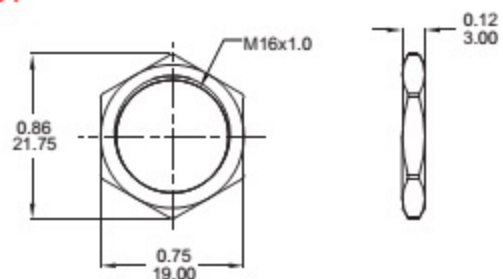

**SPECIFICATIONS****MECHANICAL LIFE:** 100,000 make-and-break cycles.**ELECTRICAL LIFE:** 50,000 cycles.**CONTACT RESISTANCE:** 200 mΩ max. initial @ 2-4VDC 100mA**CONTACT RATING:** 0.4Volt-Amps(VA) max.@20V max(AC or DC)**OPERATING POSITION:** 0.65±0.2mm.**OPERATING FORCE:** 630±130gf.**INSULATION RESISTANCE:** 100 MΩ min.**DIELECTRIC STRENGTH:** 1,000 V RMS@sea level.**OPERATING TEMPERATURE:** -30°C to 85°C.**PANEL THICKNESS:** 1.5 mm (.059) min. - 4 mm (.157) max.**TORQUE:** 2.2 Nm max. applied to nut.**MATERIALS****HOUSING & BUSHING:** Nylon 6/6.**BUTTON:** Stainless steel.**ACTUATOR:** Silicon.**CONTACT / TERMINALS:** Copper alloy,with gold plated.**SCHEMATIC / PANEL MOUNTING****FUNCTION:** Momentary action**PANEL CUTOUT****DIMENSION****M1**

Part No. Shown : PY063S2011X0M1R01

O-RING

FCP-PY02

NUT

MNU-PY01