



DESCRIPTION

- * Detachable design for operation and contact parts, easy installation.
- * Operation Part is possessed of Illuminated Pushbutton function, Pushbutton function and Indicator function.
- * Available Size: Rectangular 18 x 24mm
Square 18 x 18mm & 24 x 24mm
Round: diameter ø 18mm
- * With multiple functional bezel, the above shapes can be suitable for different panel like Mosaic panel.
- * IP65 degree for water-proof, liquid and oil prevention enables the device to be used in different field equipments.
- * Applied UL94 V0 high grade fire prevention plastic material.
- * High bezel designed to prevent the accidental touch when installing the device.
- * Can be engraved or marked with different signs on lens with many color options.
- * Illuminated with incandescent, LED and fluorescent light to have a better effect
- * Easy disassembly and additional contacts are available.
- * With special terminal design, it can be used in different PCBs by using soldering or socketing terminal.
- * Precision design enables the device with longer mechanical life by operation under the normal environment.
- * Mechanical life: Momentary 2 million operations min.
- * Approvals: UL/CUL/VDE/CE

SPECIFICATIONS

Electrical Rating	250V AC 5A(VDE) 125V AC 8A	Quick-Connect Terminal	2.8 x 0.5mm
Insulation Resistance	50mΩ(initial)according 512-2 to IEC	Wire Range	1x1.5mm ² max
Mechanical Life	momentary: 2 million operations min	Cable Range	2x0.75mm ² /1x1.0mm ² Max
Electrical Life	50,000 operations min	Lighting	LED/incandescent/neon
Insulation Withstand Voltage	1500V AC 60Hz 1min. between all terminals and ground	Storage Temperature	-40°C~+70°C
Actuating Force	1a1b:0.5kgf / 2a2b:0.8kgf	Operating Temperature	-25°C~+55°C
Contact Material	Silver	Degree of Contamination	class II
Terminal	Soldering / plug-in type	Degree of Protection	IP65

ORDER INFORMATION

MODEL FORMAT ADA16S6-**1****2****3**-**4****2****5****6**

1 OPTIONAL FUNCTION

M : MOMENTARY
A : ALTERNATE

2**3** HEAD SHAPE

R1 : ROUND, LOW BEZEL
R2 : ROUND, HIGH BEZEL
S1 : SQUARE, LOW BEZEL
S2 : SQUARE, HIGH BEZEL
T1 : RECTANGULAR, LOW BEZEL
T2 : RECTANGULAR, HIGH BEZEL
A5 : SQUARE(□24), FULL GUARD

4 CONTACT ARRANGEMENT

A : 1NO/1NC+1NO/1NC
B : 1NO/1NC

5 LAMPS

0 : Without lamps
A : Incandescent 6V AC/DC 200mA
B : Incandescent 14V AC/DC 80mA
C : Incandescent 28V AC/DC 40mA
D : Incandescent 48V AC/DC 25mA
E : Incandescent 60V AC/DC 20mA
F : Neon 110V AC
G : Neon 220V AC
H : LED 6V DC
J : LED 12V DC
K : LED 24V DC
L : Incandescent 33V AC/DC 35mA
M : Incandescent 6V AC/DC 40mA
N : Incandescent 14V AC/DC 40mA

6 LENS COLOR

B : Blue
G : Green
O : Orange
R : Red
W : White
Y : Yellow

2**3**

R1



R2



S1



S2



T1



T2



A5

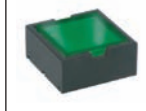



ADA16-A

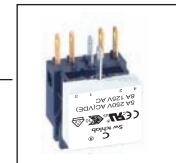

ADA16-B



unit: mm

SHAPE				
DIMENSIONS	Ø 18	18x18	18x24	24x24
COLOR	B.G.O.R.W.Y	B.G.O.R.W.Y	B.G.O.R.W.Y	B.G.O.R.W.Y

HEAD SHAPE

ADA16S6-AR2-A2
 ADA16S6-MR2-A2

ADA16S6-AS2-A2
 ADA16S6-MS2-A2

ADA16S6-AT2-A2
 ADA16S6-MT2-A2

ADA16S6-AA5-A1
 ADA16S6-MA5-A1

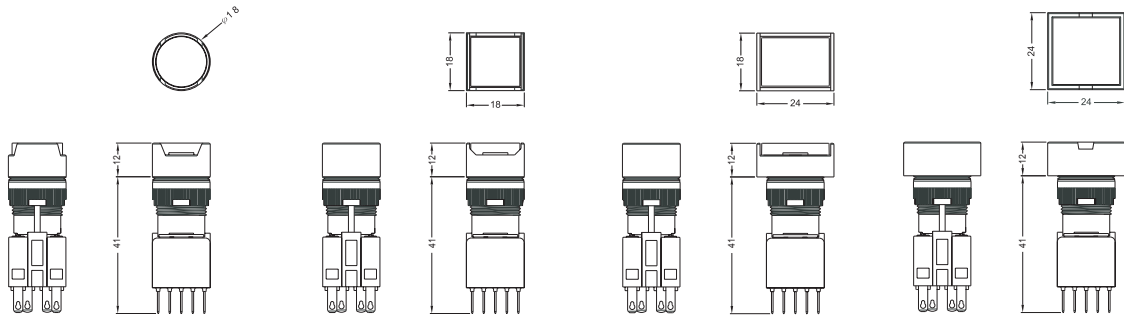

MOUNTING DIMENSIONS

Panel Thickness 0.5 To 5.0

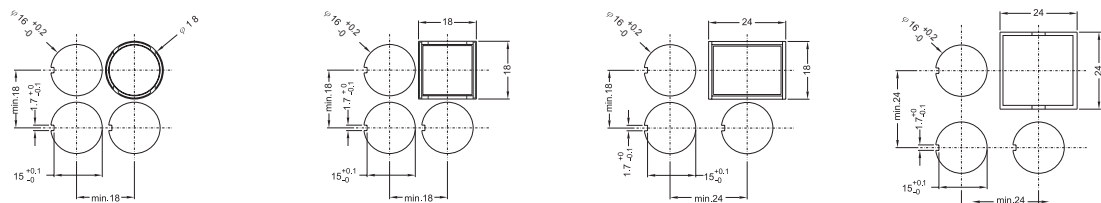



DESCRIPTION

- * Detachable design for operation and contact parts, easy installation.
- * Operation Part is possessed of illuminated Pushbutton function, Pushbutton function and Indicator function.
- * Available Size: Rectangular 24 x 30mm
Square 24 x 24mm
Round: diameter ø 25mm
- * With multiple functional bezel, the above shapes can be suitable for different panels like Mosaic panel.
- * IP65 degree for water-proof, liquid and oil prevention enables the device to be used in different field equipments.
- * Applied UL94 V0 high grade fire prevention plastic material.
- * High bezel designed to prevent the accidental touch when installing the device.
- * Can be engraved or marked with different signs on lens with many color options.
- * Illuminated with incandescent, LED and fluorescent light to have a better effect.
- * Easy disassembly and additional contacts are available.
- * With special terminal design, it can be used in different PCBs by using soldering or socketing terminal.
- * Precision design enables the device with longer mechanical life by operation under the normal environment.
- * Mechanical life: Momentary 2 million times.
- * Approvals: UL/CUL/VDE/CE

SPECIFICATIONS

Electrical Rating	250V AC 5A(VDE) 125V AC 8A	Quick-Connect Terminal	2.8 x 0.5mm
Insulation Resistance	50mΩ(initial)according 512-2 to IEC	Wire Range	1x1.5mm ² max
Mechanical Life	momentary: 2 million operations min	Cable Range	2x0.75mm ² /1x1.0mm ² Max
Electrical Life	50,000 operations min	Lighting	LED/incandescent/neon
Insulation Withstand Voltage	1500V AC 60Hz 1min. between all terminals and ground	Storage Temperature	-40°C~+70°C
Actuating Force	1a1b:0.5kgf / 2a2b:0.8kgf	Operating Temperature	-25°C~+55°C
Contact Material	Silver	Degree of Contamination	class II
Terminal	Soldering / plug-in type	Degree of Protection	IP65

ORDER INFORMATION

MODEL FORMAT ADA16S6-**1****2**3-**3****2****4****5**

1 OPTIONAL FUNCTION

- M : MOMENTARY
- A : ALTERNATE

2 LENS SHAPE

- R : ROUND
- S : SQUARE
- T : RECTANGULAR

3 CONTACT ARRANGEMENT

- A : 1NO/1NC+1NO/1NC
- B : 1NO/1NC

4 LAMPS

- O : Without lamps
- A : Incandescent 6V AC/DC 200mA
- B : Incandescent 14V AC/DC 80mA
- C : Incandescent 28V AC/DC 40mA
- D : Incandescent 48V AC/DC 25mA
- E : Incandescent 60V AC/DC 20mA
- F : Neon 110V AC
- G : Neon 220V AC
- H : LED 6V DC
- J : LED 12V DC
- K : LED 24V DC
- L : Incandescent 33V AC/DC 35mA
- M : Incandescent 6V AC/DC 40mA
- N : Incandescent 14V AC/DC 40mA

5 LENS COLOR

- B : Blue
- G : Green
- O : Orange
- R : Red
- W : White
- Y : Yellow



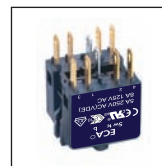

ADA16-A

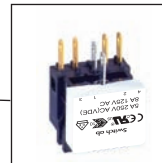

ADA16-B



unit: mm

SHAPE			
DIMENSIONS	Ø 25	24x24	24x30
COLOR	B.G.O.R.W.Y	B.G.O.R.W.Y	B.G.O.R.W.Y

HEAD SHAPE

ADA16S6-AR3-A2 □□
ADA16S6-MR3-A2 □□

ADA16S6-AS3-A2 □□
ADA16S6-MS3-A2 □□

ADA16S6-AT3-A2 □□
ADA16S6-MT3-A2 □□

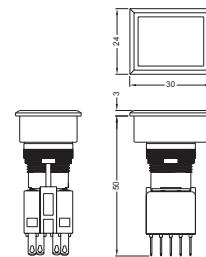
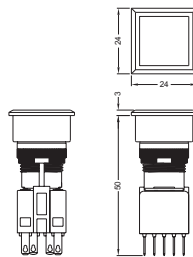
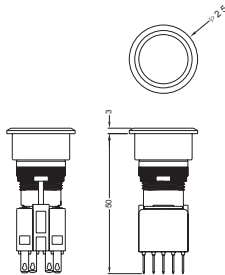

MOUNTING DIMENSIONS

Panel Thickness 0.5 To 5.0

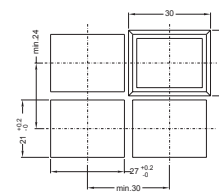
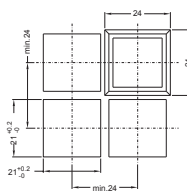
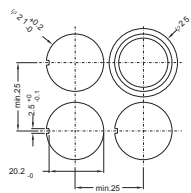



DESCRIPTION

- * Wider light diffusion enables this device to be seen within wider range.
- * Available Size: Rectangular 18 x 24mm
Square 18 x 18mm
- * Easy assembly and disassembly.
- * Color lens available: Red, Orange, Yellow, Green, Blue, White; engraving on lens or marking available on request.
- * Illuminated by incandescent, LED and Fluorescent light to have a better effect.
- * With both momentary and alternate functions
- * IP65 degree for water-proof, liquid and oil-proof enables the device to be used in equipments of different fields.
- * Applied UL94 V0 high grade fire prevention plastic material.
- * Mechanical Life: Momentary 2 million times.
- * Approvals: UL/CUL/VDE/CE pending

SPECIFICATIONS

Electrical Rating	250V AC 5A 125V AC 8A	Quick-Connect Terminal	2.8 x 0.5mm
Insulation Resistance	50mΩ(initial)according 512-2 to IEC	Wire Range	1x1.5mm ² max
Mechanical Life	momentary: 2 million operations min	Cable Range	2x0.75mm ² /1x1.0mm ² Max
Electrical Life	50,000 operations min	Lighting	LED/incandescent/neon
Insulation Withstand Voltage	1500V AC 60Hz 1min. between all terminals and ground	Operating Temperature	-25°C~+55°C
Actuating Force	1a1b:0.5kgf / 2a2b:0.8kgf	Degree of Contamination	class II
Contact Material	Silver	Degree of Protection	IP65
Terminal	Soldering / plug-in type		

ORDER INFORMATION

MODEL FORMAT ADA16S6-**1****2**4-**3****1****4****5**

1 OPTIONAL FUNCTION

M : MOMENTARY
A : ALTERNATE

2 LENS SHAPE

S : SQUARE
T : RECTANGULAR

3 CONTACT ARRANGEMENT

A : 1NO/1NC+1NO/1NC
B : 1NO/1NC

4 LAMPS

O : Without lamps
A : Incandescent 6V AC/DC 200mA
B : Incandescent 14V AC/DC 80mA
C : Incandescent 28V AC/DC 40mA
D : Incandescent 48V AC/DC 25mA
E : Incandescent 60V AC/DC 20mA
F : Neon 110V AC
G : Neon 220V AC
H : LED 6V DC
J : LED 12V DC
K : LED 24V DC
L : Incandescent 33V AC/DC 35mA
M : Incandescent 6V AC/DC 40mA
N : Incandescent 14V AC/DC 40mA

5 LENS COLOR

B : Blue
G : Green
O : Orange
R : Red
W : White
Y : Yellow



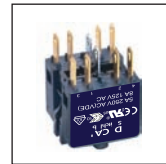

ADA16-A



ADA16-B



unit: mm

SHAPE		
DIMENSIONS	18x18	18x24
COLOR	B.G.O.R.W.Y	B.G.O.R.W.Y

HEAD SHAPE

ADA16S6-AS4-A1
 ADA16S6-MS4-A1

ADA16S6-AT4-A1
 ADA16S6-MT4-A1

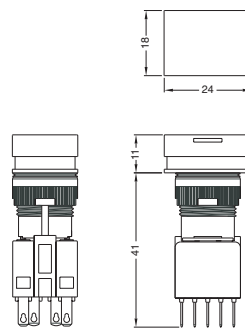
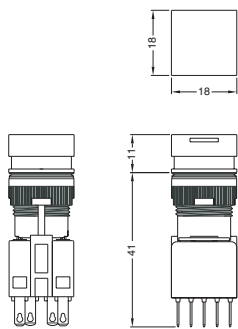

MOUNTING DIMENSIONS

Panel Thickness 0.5 To 5.0

