

## 更經濟且實用性高的封裝開關

- 1,000萬次以上的高壽命、並通過內置微動開關，實現高重複精度高精度封裝開關
- 可在強度，防塵性，防滴性要求高的場合使用還有將端子用樹脂固定的塑封端子型
- 面板安裝型的動作位置和SLZ型相同
- 符合UL,CUL,CCC & CE的安全規格

### Economical and High Utility Enclosed Switch

- Enclosed Switches with Built-in Basic Switches for High Repeatability and Durability of 10 Million Operations Minimum.
- Panel mount versions have the same operating position as SLZ type of switch.
- Suitable for applications demanding higher mechanical strength, dustproof and drip-proof properties than those on basic switches. Resin molded terminal versions are available.
- UL,CUL,CCC & CE approved.

### ■ 性能 Characteristics

保護結構 Degree of protection		IP67
壽命 Durability	機械性 Mechanical	10,000,000 operations min.
	電器性 Electrical	500,000 operations min.
容許操作速度 Operating Speed		0.05mm/s~0.5m/s
容許操作頻率 Operating Frequency	機械性 Mechanical	120 operations /min
	電器性 Electrical	20 operations /min
額定頻率 Rated Frequency		50/60Hz
絕緣阻抗(絕緣電阻) Insulation Resistance		100MΩ min.(at 500VDC)
接觸阻抗(接點電阻) Contact Resistance		15mΩ max. (initial value for the built-in switch when tested alone)
耐電壓 Dielectric Strength	同極端子間 Between terminals of same polarity	1,000 VAC 50/60Hz for 1min
	充電金屬部與接地端間 Between current-carrying metal parts and ground	2,000 VAC 50/60Hz 1min
	各端子與非充電金屬部間 Between each terminal and non-current-carrying metal part	AC2,000V 50/60Hz for 1min
額定絕緣電壓 (Ui) Rated insulation voltage (Ui)		1,000VAC
污染度 (使用環境) Pollution degree (Application environment)		3 (IEC947-5-1)
額定動作電流(Ie) Rated operating current(Ie)		10A
觸電保護等級 Degree of protection against electric shock		Class II
振動 Vibration Resistance	誤動作 Malfunction	10-55 Hz 1.5 mm double amplitude (雙振幅)
衝擊 Shock Resistance	耐久 Destruction	1,000m/s <sup>2</sup> min.
	誤動作 Malfunction	100m/s <sup>2</sup> min.
使用環境溫度 Ambient operating temperature range		-10°C~+80°C with no icing (不結冰)
使用環境濕度 Ambient operating humidity range		35% ~ 95%RH
包裝說明 Packing		10pcs /Box

★備註 1.以上為初始值 2.上述性能內容將因機種型式而有所不同請另行洽詢 3.上述壽命值是為周圍溫度5-35度C，周圍濕度40-70%RH時之條件。如您需要其它詳細條件，請另行洽詢。

★Note: 1. Above values of these characteristics are initial values. 2. Above values of these characteristics may be depending on different models. If any requirements, pls contact our DECA sales representative. 3. Above durability is for an ambient temperature of 5 to 35°C and ambient humidity of 40% to 70%. If any requirements, pls contact our DECA sales representative.

### SL4MC-07

- 面板安裝柱塞型  
Panel Mount Plunger

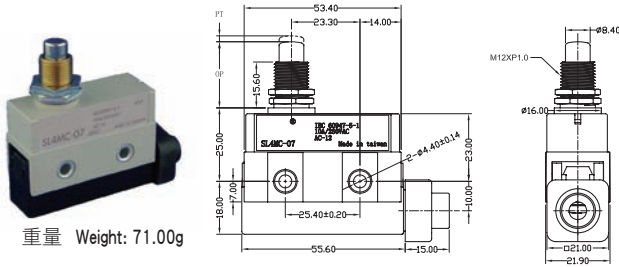

重量 Weight: 71.00g

### SL4MC-26

- 面板安裝滾輪·柱塞型  
Panel Mount Roller Plunger

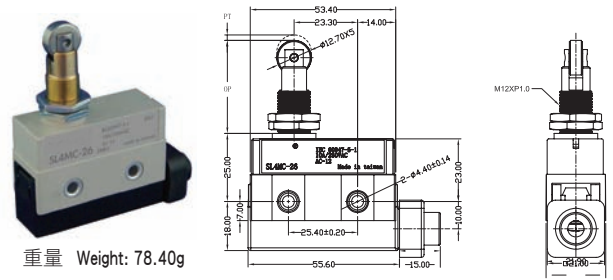

重量 Weight: 78.40g

### SL4MC-27

- 面板安裝橫向滾輪·柱塞型  
Panel Mount Crossroller Plunger

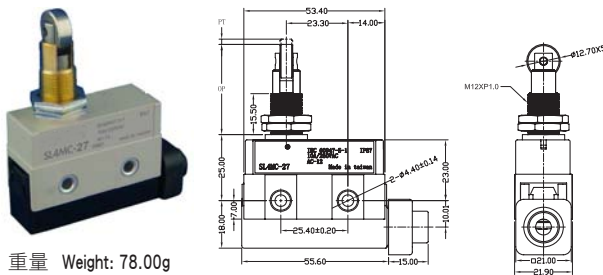

重量 Weight: 78.00g

### SL4MC-43

- 臥式標準滾輪擺桿型  
Hinge Roller Lever

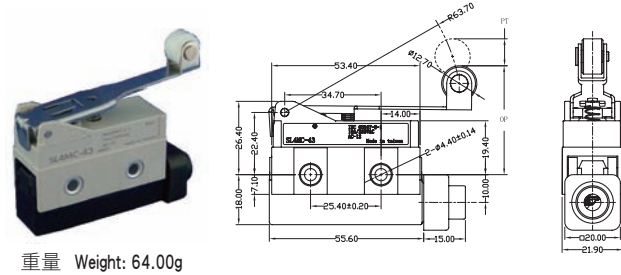

重量 Weight: 64.00g

### SL4MC-44

- 滾輪短擺桿型  
Short Hinge Roller Lever

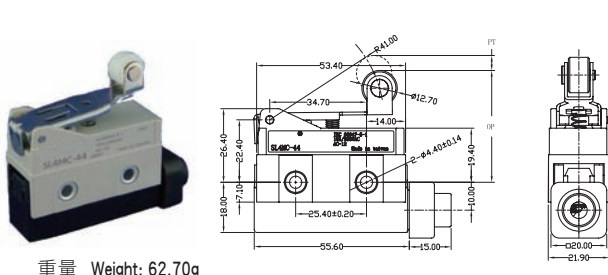

重量 Weight: 62.70g

### SL4MC-48

- 單向動作滾輪短擺桿型  
One-Way Action Short Hinge Roller Lever

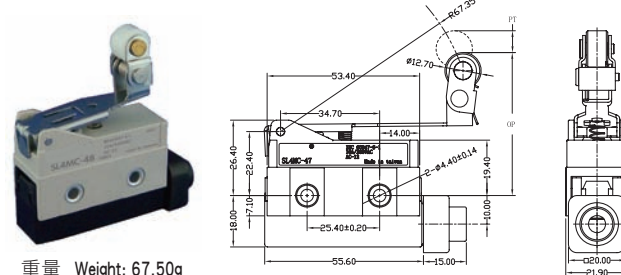

重量 Weight: 67.50g

### SL4MC-60

- 標準擺桿型  
Hinge Lever

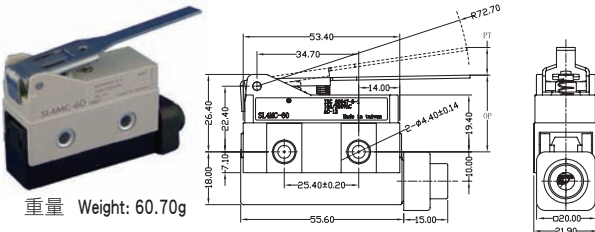

重量 Weight: 60.70g

### SL4MC-61

- 短擺桿型  
Short Hinge Lever

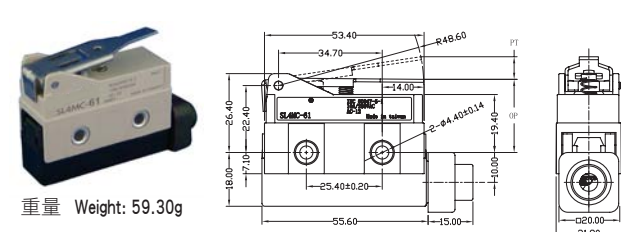

重量 Weight: 59.30g

### ■ 動作特性 Operating Characteristics

O.Characteristics		Model	SL4MC-07	SL4MC-26	SL4MC-27	SL4MC-43	SL4MC-44	SL4MC-48	SL4MC-60	SL4MC-61
動作力	OF	MAX	5.88N	5.88N	5.88N	1.96N	2.94N	2.94N	1.67N	2.55N
回復力	RF	MIN	0.98N	0.98N	0.98N	0.39N	0.39N	0.39N	0.25N	0.34N
預行程	PT	MAX	1.6mm	1.6mm	1.6mm	—	—	—	—	—
過行程	OT	MIN	5mm	5mm	5mm	5mm	2mm	2mm	4mm	2.5mm
應差距離	MD	MAX	0.2mm	0.2mm	0.2mm	3mm	1.5mm	1.5mm	3mm	1.7mm
自由位置	FP	MAX	—	—	—	51mm	47mm	57.2mm	36mm	33mm
動作位置	OP		21.8 ± 1.2mm	33.4 ± 1.2mm	33.4 ± 1.2mm	40 ± 1mm	40 ± 1mm	40 ± 1mm	25 ± 1mm	25 ± 1mm