

NOTE:  
 1.ALL DIMENSIONS ARE IN MILLIMETERS,BRACKETED DIMENSIONS ARE IN INCHES.  
 2.GENERAL TOLERANCES MAX.±0.20mm.  
 SPECIFICATIONS:  
 1.RATING: DC 30V 0.1A  
 2.LIFE: 10,000 cycles  
 3.OPERATION FORCE: 250gf±100gf  
 4.STROKE: 1.5+0.5/-0mm  
 5.CONTACT RESISTANCE: 50mΩ MAX.  
 6.DIELECTRIC STRENGTH: AC 50V(50Hz) 1 MINUTE  
 7.INSULATION RESISTANCE: 100MΩ MIN.  
 8.OPERATION TEMPERATURE RANGE: -10°C~+70°C

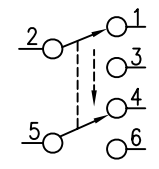

SWITCH ACTION	
normal	push
2-1	2-3
5-4	5-6

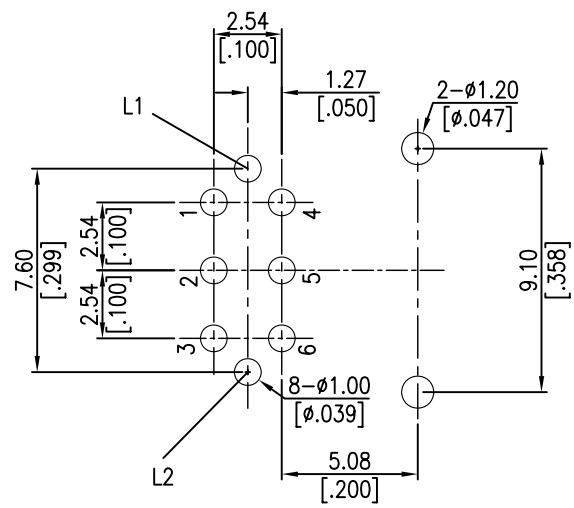
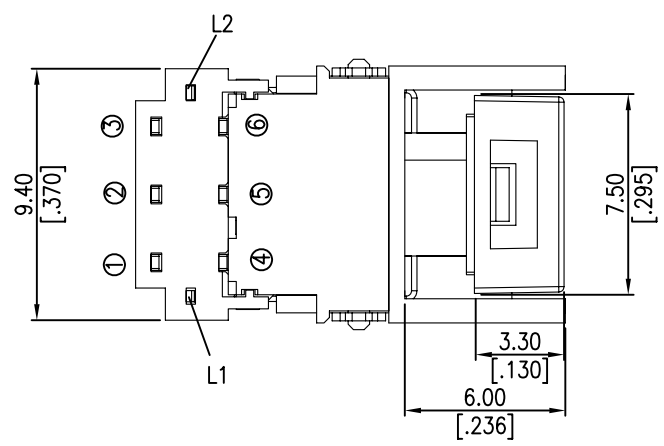
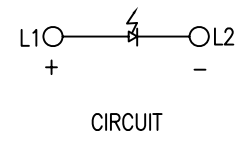

△			
△			
△			
△			
△			
SYM	DISCRIPTION	DATE	APPROVED
1			
2			
3			

**TACLEX** TACLEX ELECTRONICS CO., LTD.

TOLERANCES UNLESS OTHERWISE SPECIFIED LINEAR: ±0.30 ANGULAR: ±3°	SIGNATURES	DATE	TITLE
	DRAWN Alex	2012.03.16	LED SWITCH
	CHK'D Andy	2012.03.16	NO.
REVISIONS	SCALE	APPV'D Rex	ML8
A	5/1	2012.03.16	