

6M Series

Miniature Slide Switches for P.C. Board



SPECIFICATIONS

CONTACT RATING: Dependent upon contact material.
CONTACT RESISTANCE: 50mΩ max. initial .
MECHANICAL LIFE: 20,000 Cycles.
INSULATION RESISTANCE: 1,000MΩ min.
DIELECTRIC STRENGTH: 1,000 V RMS@sea level.
OPERATING TEMPERATURE: -40° C to 80° C.
MINIMUM LOAD: Silver: 100mA 10VDC ;Gold :10mA 50mV.
BREAKING CAPACITY: Silver: 1A 250VAC;Gold 100mA 30VDC;
 With Resistive Load.

MATERIALS

CASE - Nylon , white.
HOUSING - Nylon , black.
ACTUATOR - Nylon , black.
CONTACTS/TERMINALS- Copper alloy, with silver or gold plated.
 (See Page 102)

HOW TO ORDER

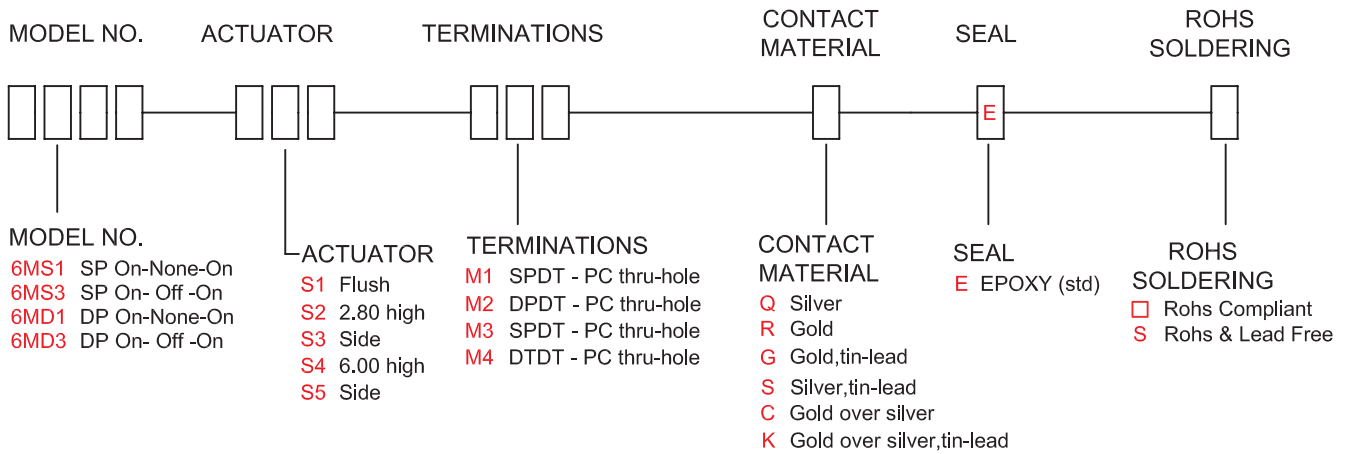

6M Miniature Slide Switches for P.C. Board

SWITCH FUNCTION

NO. POLES	MODEL NO.	SWITCH FUNCTION			CONNECTED TERMINALS			SCHEMATIC
		POS.1	POS.2	POS.3	POS.1	POS.2	POS.3	
SP	6MS1	ON	NONE	ON	2-1	OPEN	2-3	
	6MS3	ON	OFF	ON				
DP	6MD1	ON	NONE	ON	2-1,5-4	OPEN	2-3,5-6	
	6MD3	ON	OFF	ON				

MOM=MOMENTARY

POLE OPTIONS

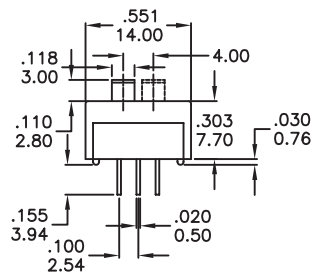
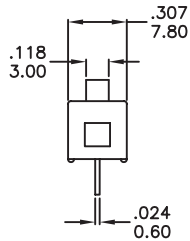

P.C MOUNTING

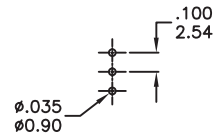

SPDT

Part No. Shown : 6MS1S2M1QE

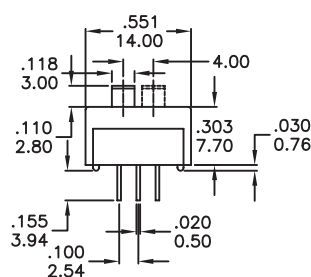
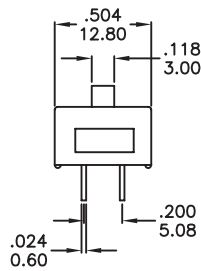

P.C MOUNTING

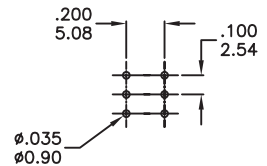

DPDT

Part No. Shown : 6MD1S2M2QE

6M Miniature Slide Switches for P.C. Board

ACTUATOR OPTIONS

S1

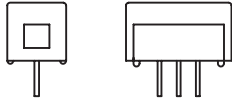

S2

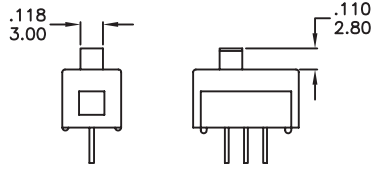

S5 ONLY DPDT

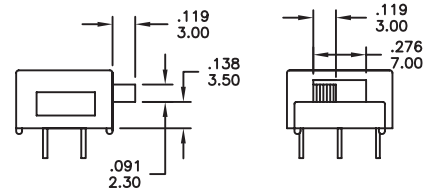

S3

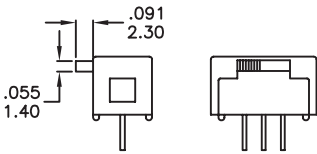

S4

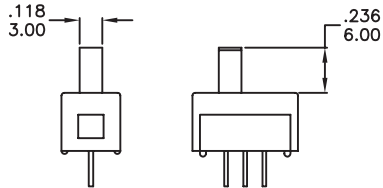

S6

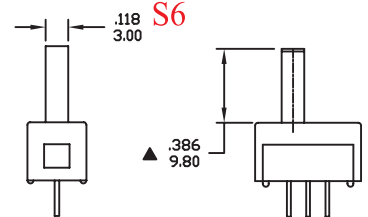

TERMINATION OPTIONS

M1

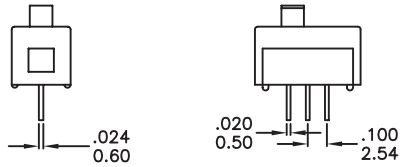

M2

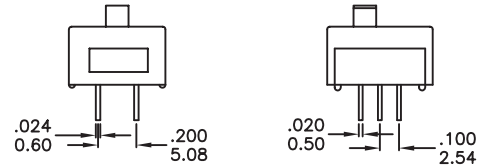

SPDT

DPDT

M3

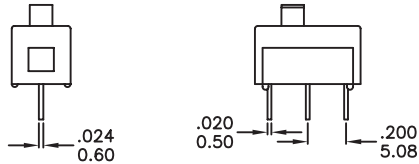

M4

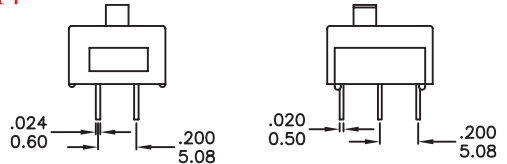

SPDT

DPDT

P.C. MOUNTING

M1

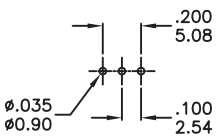

SPDT

M2

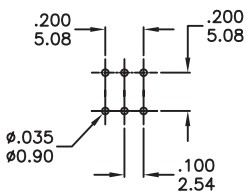

DPDT

M3

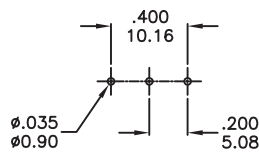

SPDT

M4

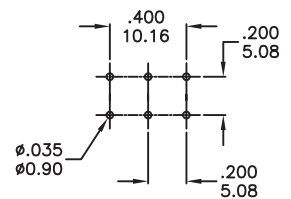

DPDT

CONTACT MATERIAL OPTIONS

	CONTACT MATERIAL	TERMINATION RATING	RATINGS
Q	Silver	Q = Silver	3 Amps with resistant load @ 120VAC or 28VDC 1 Amps with resistant load @ 250VAC
S		S = Silver,pure - tin	
C	Gold over Silver	C = Gold over silver	
K		K = Gold over silver,pure - tin	
R	Gold	R = Gold	0.4 Volt-Amps(VA)max. @ 20V max. (AC or DC)
G		G = Gold,pure - tin	



SOLDERING PROCESSES

WAVE SOLDERING : Recommended Soldering Temperature:260±5°C
Duration of Solder Immersion: 5 ±1 seconds
(PCB is 1.6mm in thickness)

SOLDERING : Vapor phase

Temperature Profile

Zone	Room temperature	Time (Sec)
Pre-heat (A)	150°C	Min 120s
Soak (B)	180°C~200°C	Min 150s
Peak (C)	200°C~235°C	Min 30s
Peak (D)	235°C~260°C	Min 40s
Peak (E)	260°C	Max 10s

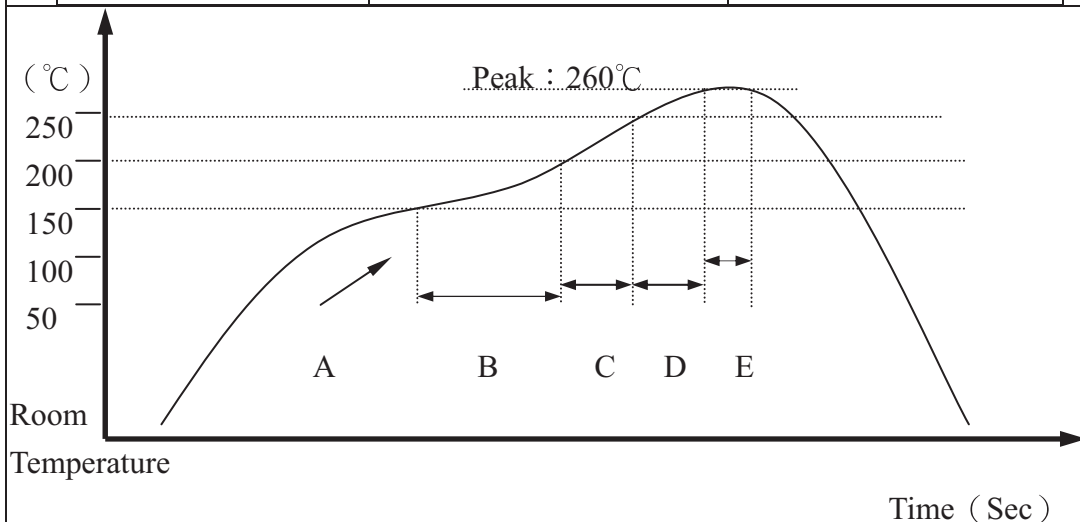

6M Miniature Slide Switches for P.C. Board