

### SPECIFICATION

1. Rating: DC 15V 2A
2. Contact resistance: 30mΩ MAX.
3. Insulation resistance: 100MΩ MIN.
4. Mechanical Life: 30,000 cycles.

### (B) MATERIALS

- CASE & HOUSING** - Glass filled Nylon 6/6, black.  
**ACTUATOR** - Glass filled Nylon 6/6, gray.  
**CONTACT** - Copper alloy, silver plated.  
**TERMINALS** - Copper alloy, silver plated.  
**PIN** - Brass, nickel plated.

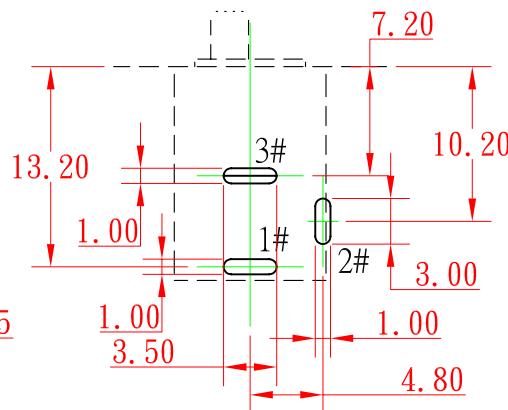
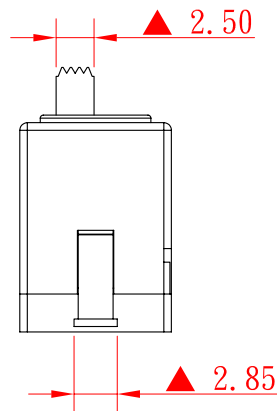

P. C. B LAYOUT  
BOTTOM VIEW

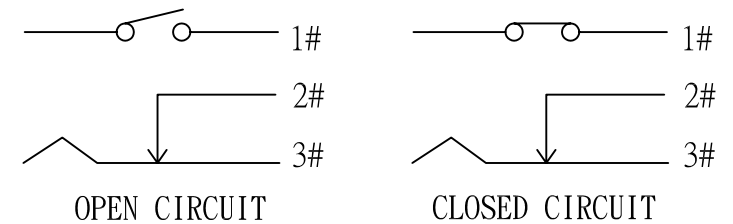

### SCHEMATIC



TACLEX ELECTRONICS CO., LTD.

符號	原尺寸	修改後尺寸	變更日期
1 (A)		增加端子尺寸標示	JAN-14-2010
2 (B)		增加MATERIAL說明	JAN-26-2010
3 (C)			
4 (D)			
5 (E)			

SCALE(比例): 2:1

TOLERANCE (公差):  
 0.00 mm ± 0.25mm  
 0.0 mm ± 0.40mm  
 ANGULAR: ± 5°  
 FILE NAME : SJ0003

TITLE 圖名	DC POWER JACK WITH SWITCHES	SIZE 圖紙	A4
DWG NO. 圖號	SJ-003		UNIT 單位
REV. 版本	C	DATE 日期	JAN - 11 - 2010
CHECKED BY 審核	RICHARD	DRAWN BY 製圖	Jason
		SHEET 張數	1 of 1